

CONTENTS SUPPLIED

- (a.) Frame
- (b.) Canopy Top
- (c.) Carry Bag

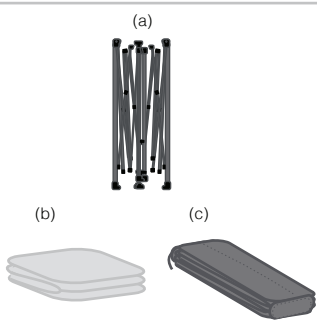

HARDWARE HIGHLIGHTS

- (a.) Peak Tensioning Device
(DO NOT crank-up until fabric is stretched)
- (b.) Velcro Sewn Inside
- (c.) Easy Release Thumb Latch

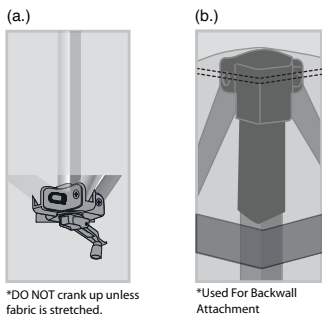

*DO NOT crank up unless fabric is stretched.

*Used For Backwall Attachment

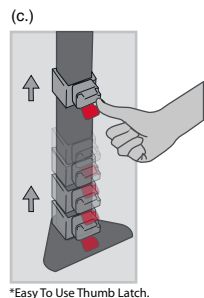

*Easy To Use Thumb Latch.

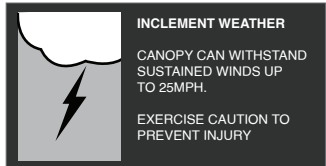

CANOPY

Assembly Instructions

STEP 1

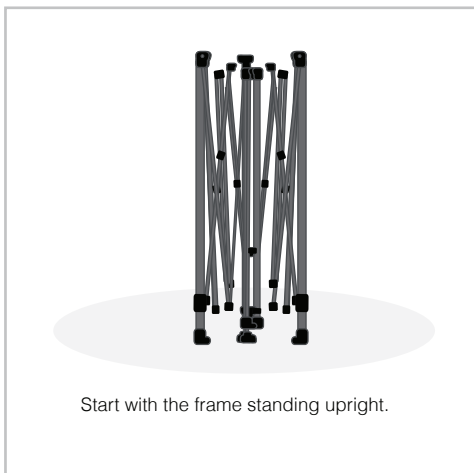

STEP 2

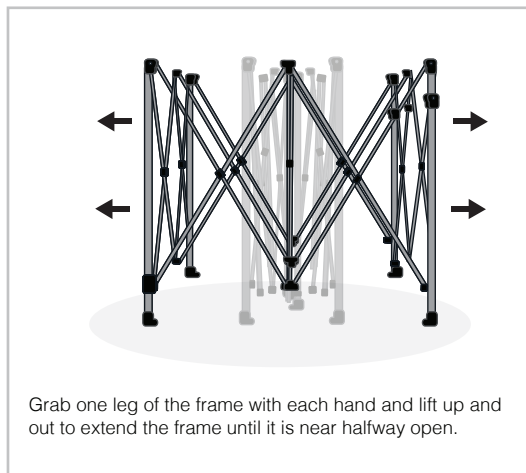

STEP 4

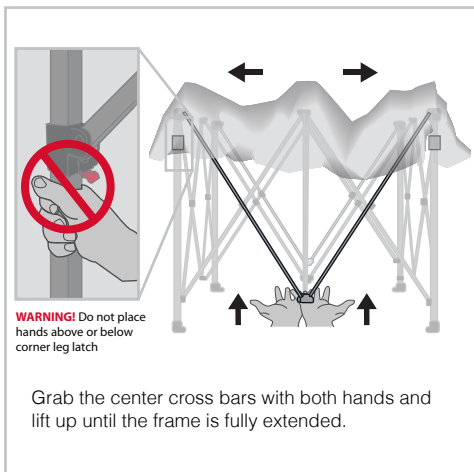

WARNING! Do not place hands above or below corner leg latch

STEP 5

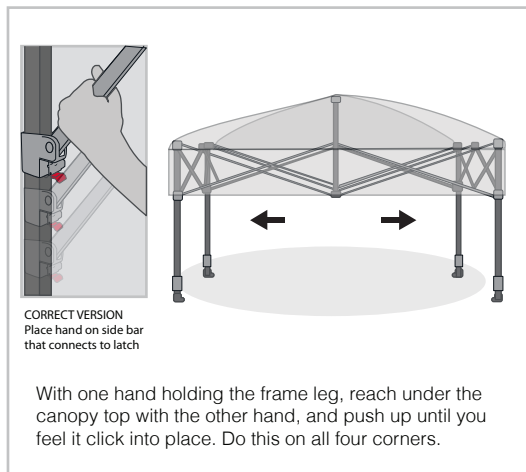

CORRECT VERSION
Place hand on side bar that connects to latch

STEP 3

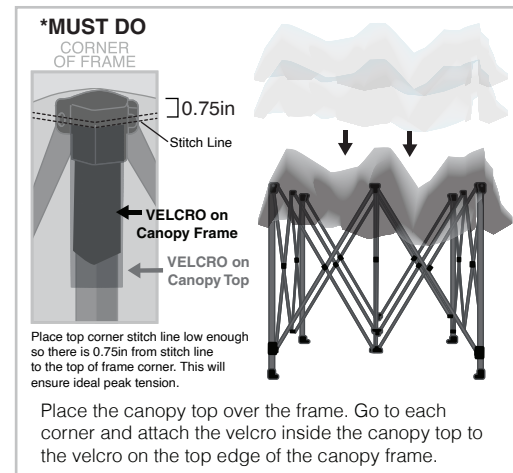

STEP 6

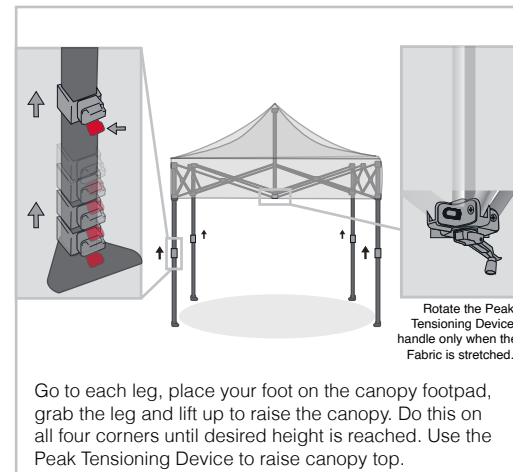

***PLEASE BE SURE TO STAKE DOWN OR WEIGH DOWN CANOPY TO PREVENT LIABILITY**